

Arts and Sciences
Uris Space Committee
2016

Arts and Science Current Space

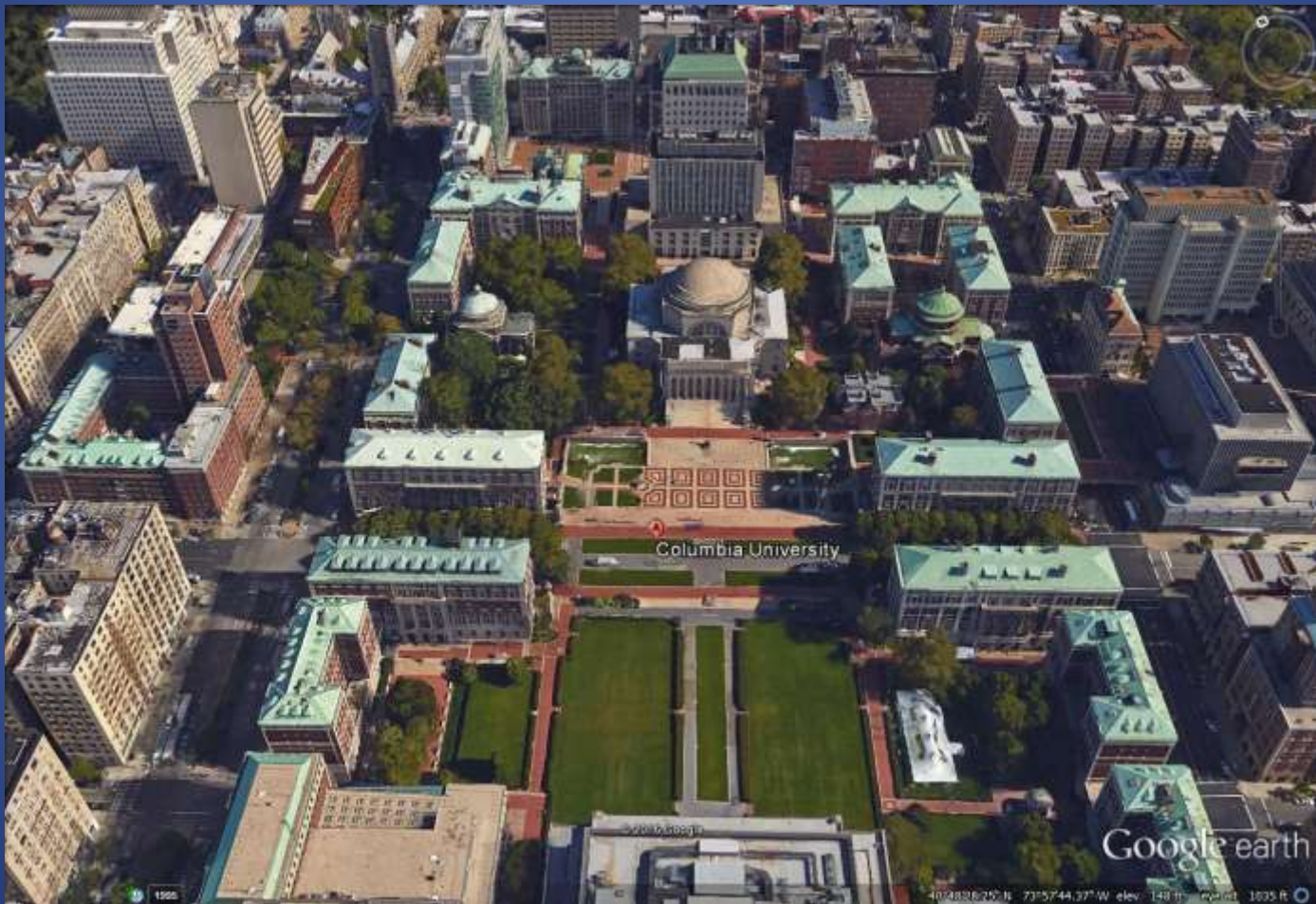

Arts and Science Current Space

Arts and Sciences occupies ~950,000 sf

65 Buildings occupied
Morningside

826,828 sf

Manhattanville

43,602 sf

Nevis Laboratories

80,780 sf

Lamont

1,322 sf

Arts & Sciences Space Distribution

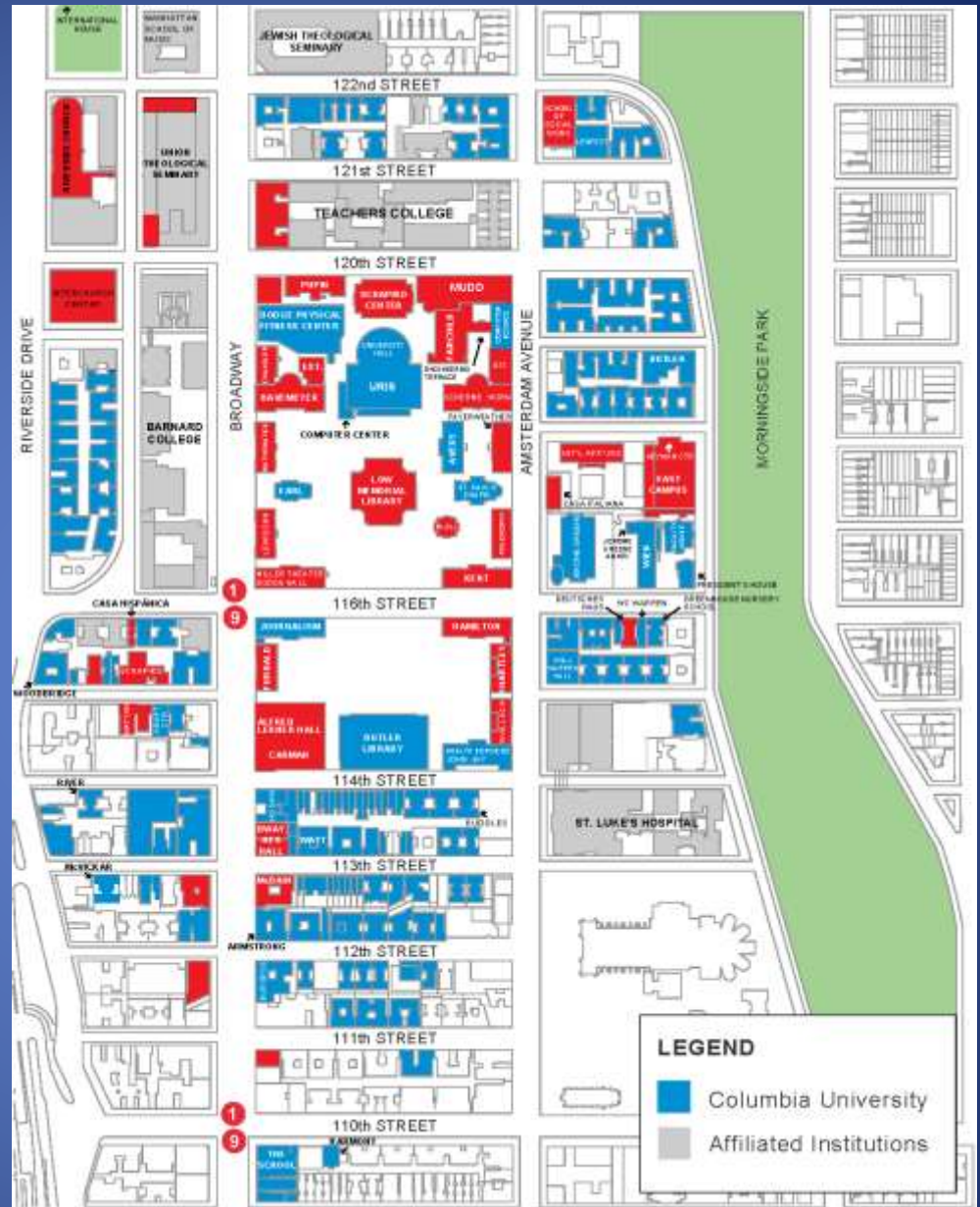
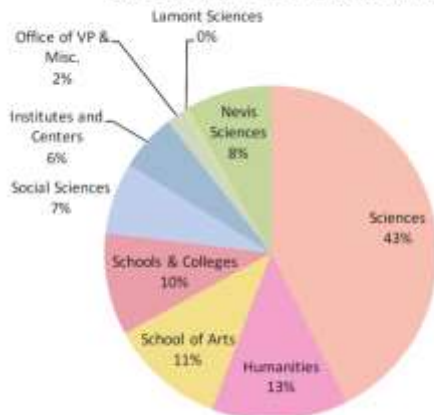

Natural Science

Departments

- Astronomy
- Biological Sciences
- Chemistry
- Earth and Environmental Sciences
- Evolution, Ecology and Environmental Biology (E3B)
- Mathematics
- Physics
- Statistics

Square Footage

Morningside

405,265 sf

Nevis Laboratories

80,780 sf

Lamont

1,322 sf

Space devoted to laboratories

212,289 sf

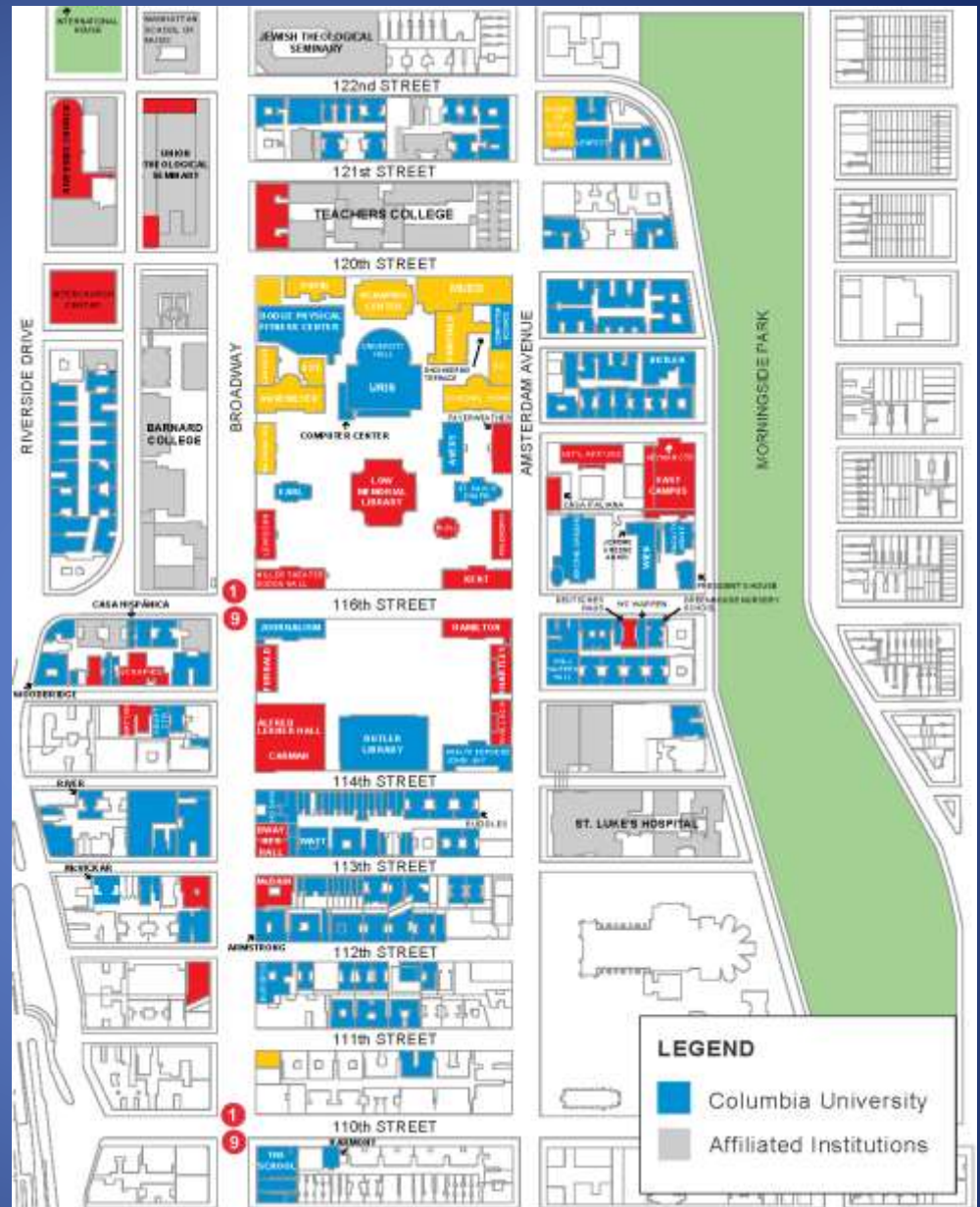

Social Science

Departments

- Anthropology
- Economics
- History
- Political Science
- Sociology

Square Footage

Morningside

66,137 sf

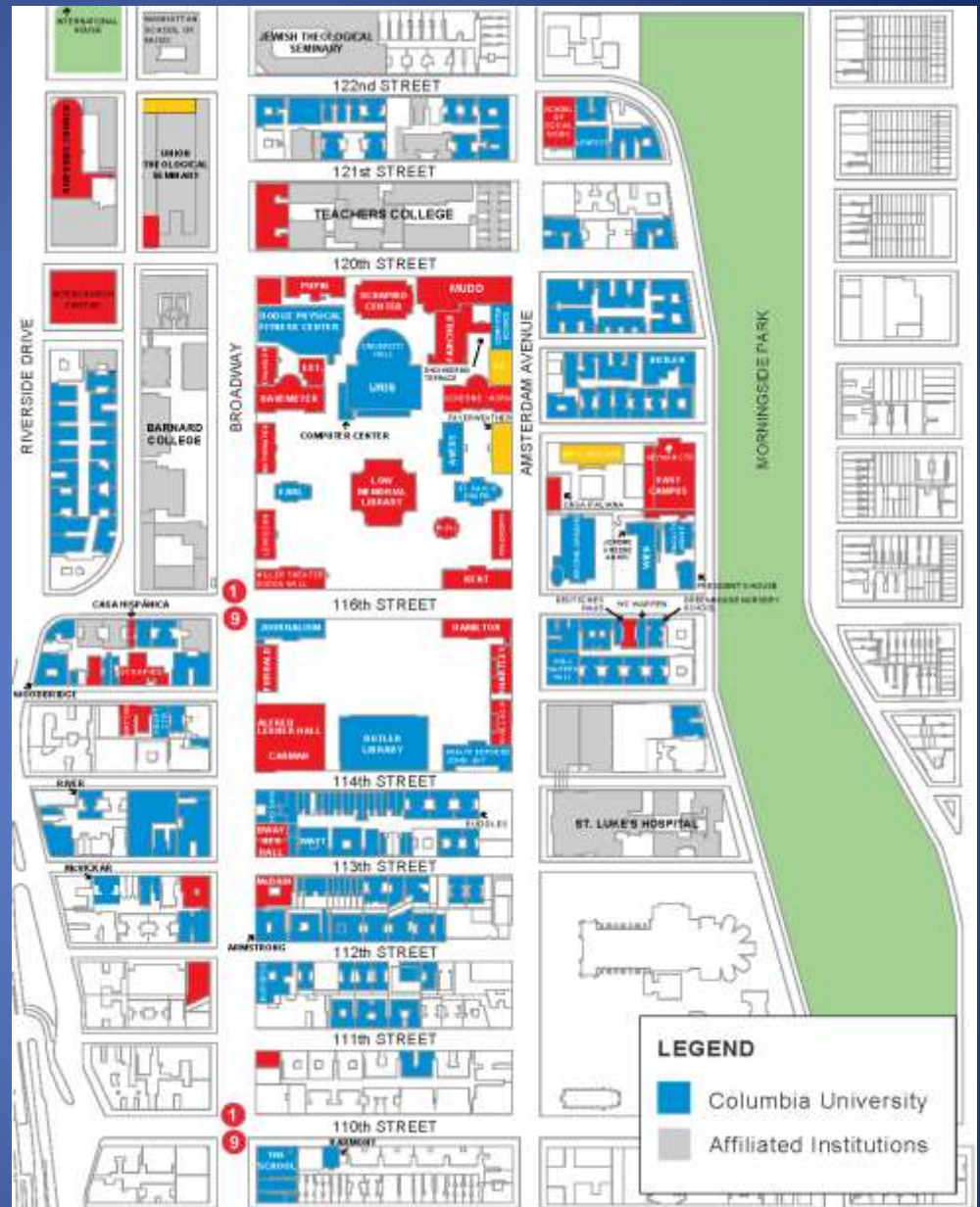

Humanities

Departments

- Art History
- Classics
- East Asian Languages and Cultures (EALAC)
- English and Comparative Literature
- French and Romance Languages
- Germanic Languages
- Italian
- Latin American & Iberian Cultures (LAIC)
- Middle Eastern, South Asian and African Studies (MESAAS)
- Music
- Philosophy
- Religion
- Slavic Languages

Square Footage

Morningside

125,991 sf

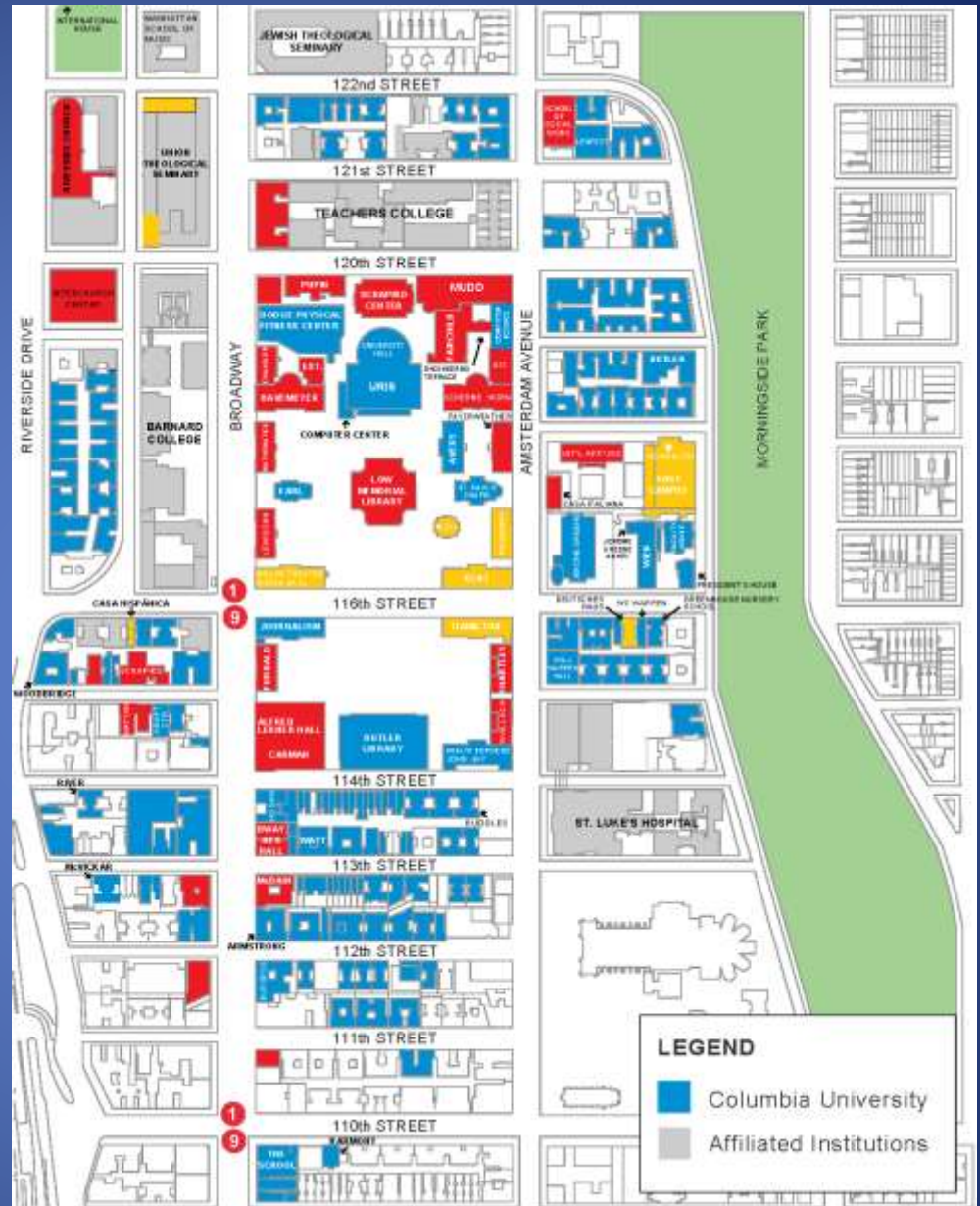

Schools

Columbia College

Square Footage

53,119 sf

Graduate School of Arts and Sciences

Square Footage

16,454 sf

School of the Arts

Square Footage

(Morningside and Manhattanville Campuses)

107,060 sf

School of General Studies

Square Footage

14,974 sf

School of Professional Studies

Square Footage

9,519 sf

Schools Total

201,126sf

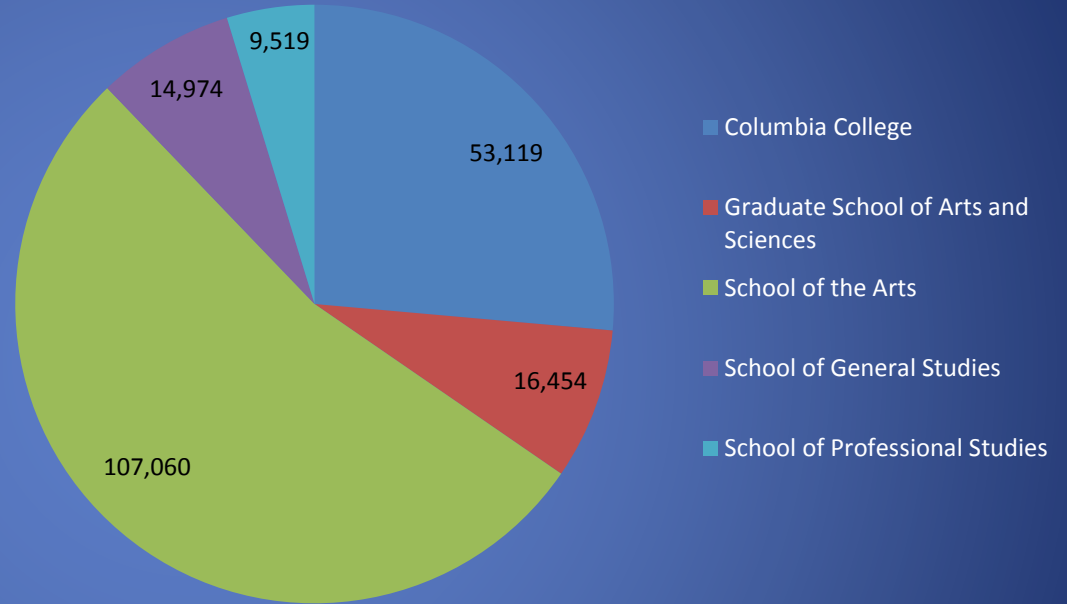

Center and Institutes

Centers for Ancient Studies space survey:	The Eastern European Center
Center for Ancient Mediterranean	The Harriman Institute
Center for African Studies	Western Heritage Center
Center for American Studies	Center for Advanced Studies in Novel Surfactants
Center for Ancient Mediterranean	Institute for Medieval Japanese Studies
Center for Ancient Mediterranean	Square Footage
Center for Ancient Mediterranean	Institute for Religion, Culture, and Public Life
Center for Ancient Mediterranean	61,845
Center for Ancient Mediterranean	Institute for Strings, Cosmology and Astroparticle Physics
Center for Ancient Mediterranean	K1 Project
Center for Ancient Mediterranean	LeRoy Neiman Center for Print Studies
Center for Ancient Mediterranean	2832 Broadway
Center for Ancient Mediterranean	2,682 sf
Center for Ancient Mediterranean	Maison Francaise
Center for Ancient Mediterranean	450 Riverside Drive
Center for Ancient Mediterranean	1,390
Center for Ancient Mediterranean	Casey Research Science and Engineering Center
Center for Ancient Mediterranean	149
Center for Ancient Mediterranean	Fayerweather
Center for Ancient Mediterranean	1,015
Center for Ancient Mediterranean	Nanoscale Science and Engineering Center
Center for Ancient Mediterranean	Hamilton Hall
Center for Ancient Mediterranean	2,696
Center for Ancient Mediterranean	Nevis Laboratories
Center for Ancient Mediterranean	6,509
Center for Ancient Mediterranean	Heyman Center
Center for Ancient Mediterranean	30,824
Center for Ancient Mediterranean	Paul F. Lazarsfeld Center for the Social Sciences
Center for Ancient Mediterranean	IAB
Center for Ancient Mediterranean	7,170
Center for Ancient Mediterranean	The Center for Korean Research
Center for Ancient Mediterranean	7,545
Center for Ancient Mediterranean	The East Central European Center
Center for Ancient Mediterranean	Nevis
Center for Ancient Mediterranean	10,326
Center for Ancient Mediterranean	Prentis
Center for Ancient Mediterranean	845
Center for Ancient Mediterranean	Riverside Church
Center for Ancient Mediterranean	1,330
Center for Ancient Mediterranean	Schermerhorn Extension
Center for Ancient Mediterranean	3,710

Rented Spaces

Riverside Church

- School of the Arts
 - Institute for the Study of Human Rights
- 9,599 sf
\$416,395

729 7th Avenue (between 48th and 49th)

- School of Professional Studies
- 5,038 sf

Total Rented Space \$200,156
excluding classrooms:

540 West 122nd Street

School of Social Work

- Statistics Department
- 16,120 sf
\$1,166,022

- INCITE
- 36,639 sf
1,900 sf
\$57,053

Total Annual Cost of Rented Space:
90 Morningside Drive

Banco Popular

- Gates Foundation
 - Journal of Philosophy
 - Center for Environment, Economy and Society
- 2,682 sf
\$165,852

- E3B
- \$2,235,778
1,300
\$44,850

Classroom Rentals

- Kraft Center for Jewish Student Life
 - Union Theological Seminary
 - School of Social Work
 - Teacher's College
- \$185,450

URIS Hall



Uris Hall Facts

Built in 1960's

Ten Floors, Eight Inhabitable

Current Occupants

Columbia Business School

Thomas J. Watson Business and
Economics Library

Total faculty: 142

Divided into five academic units:

- Accounting
- Decision, Risk, and Operations
- Finance and Economics
- Management
- Marketing

Total Admin: 355

Total Student Body: ~1,500

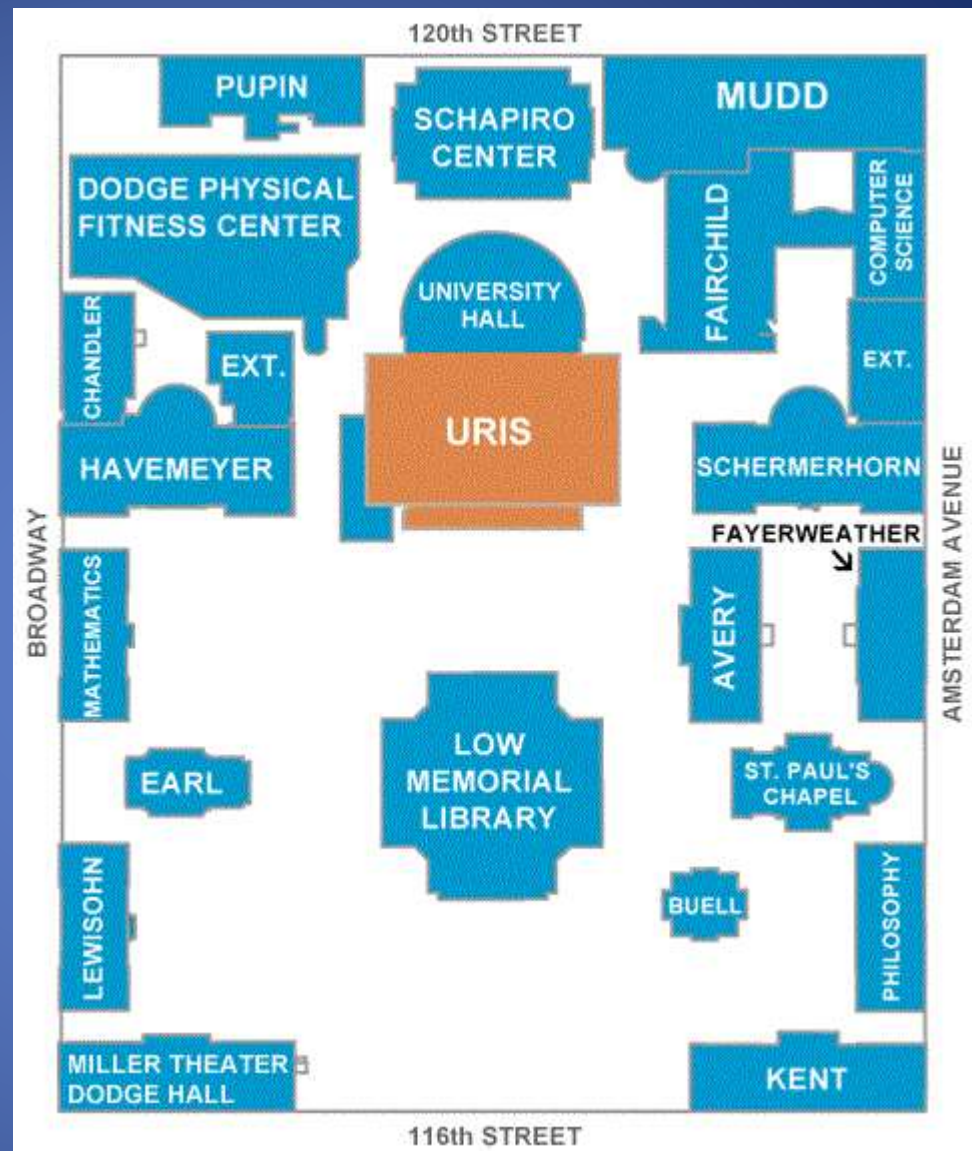

Uris 1st Floor

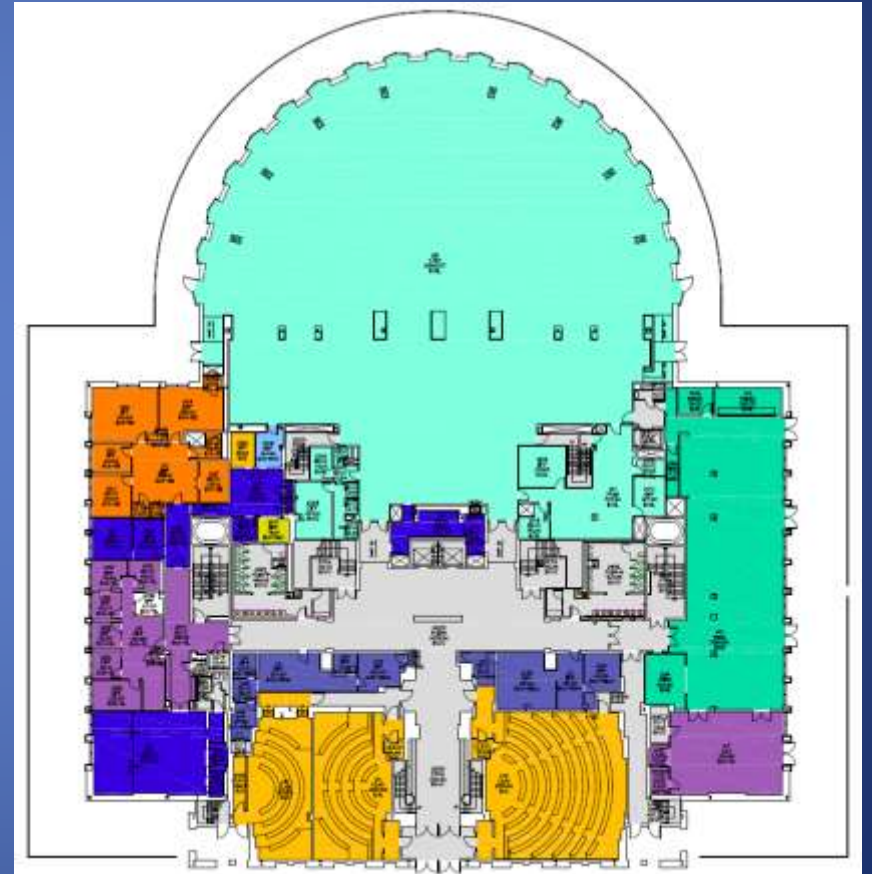
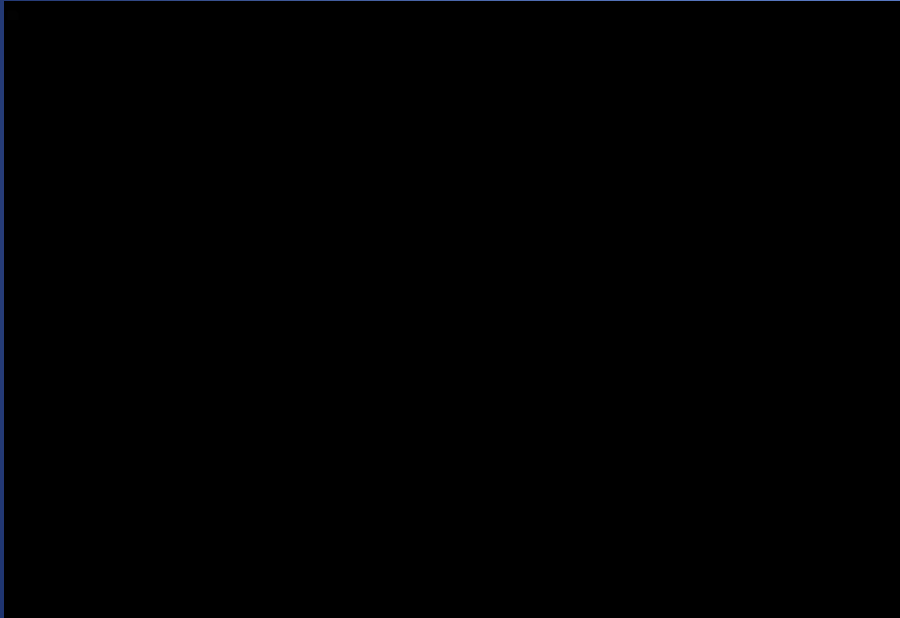

Uris 2nd Floor

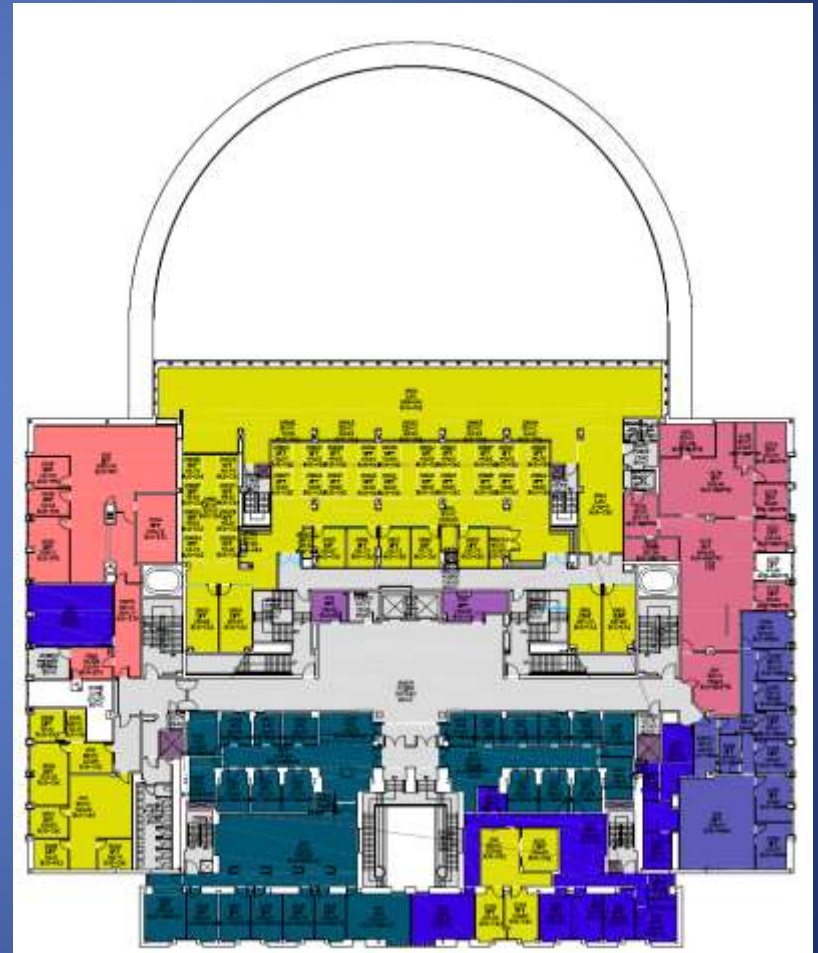

Uris 3rd Floor

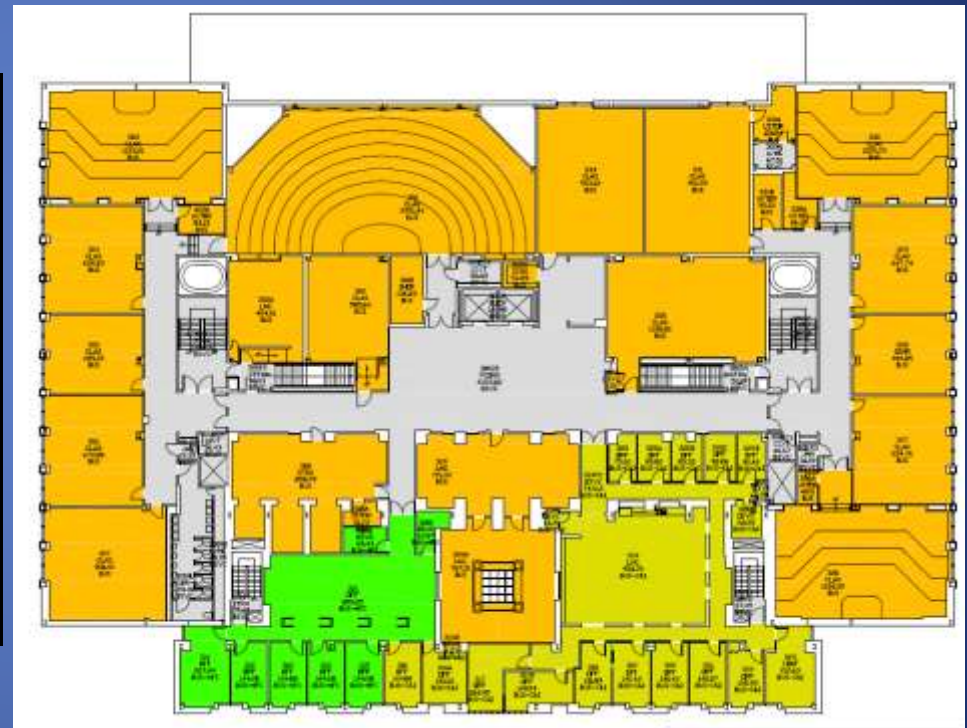

Uris 4th – 7th Floors

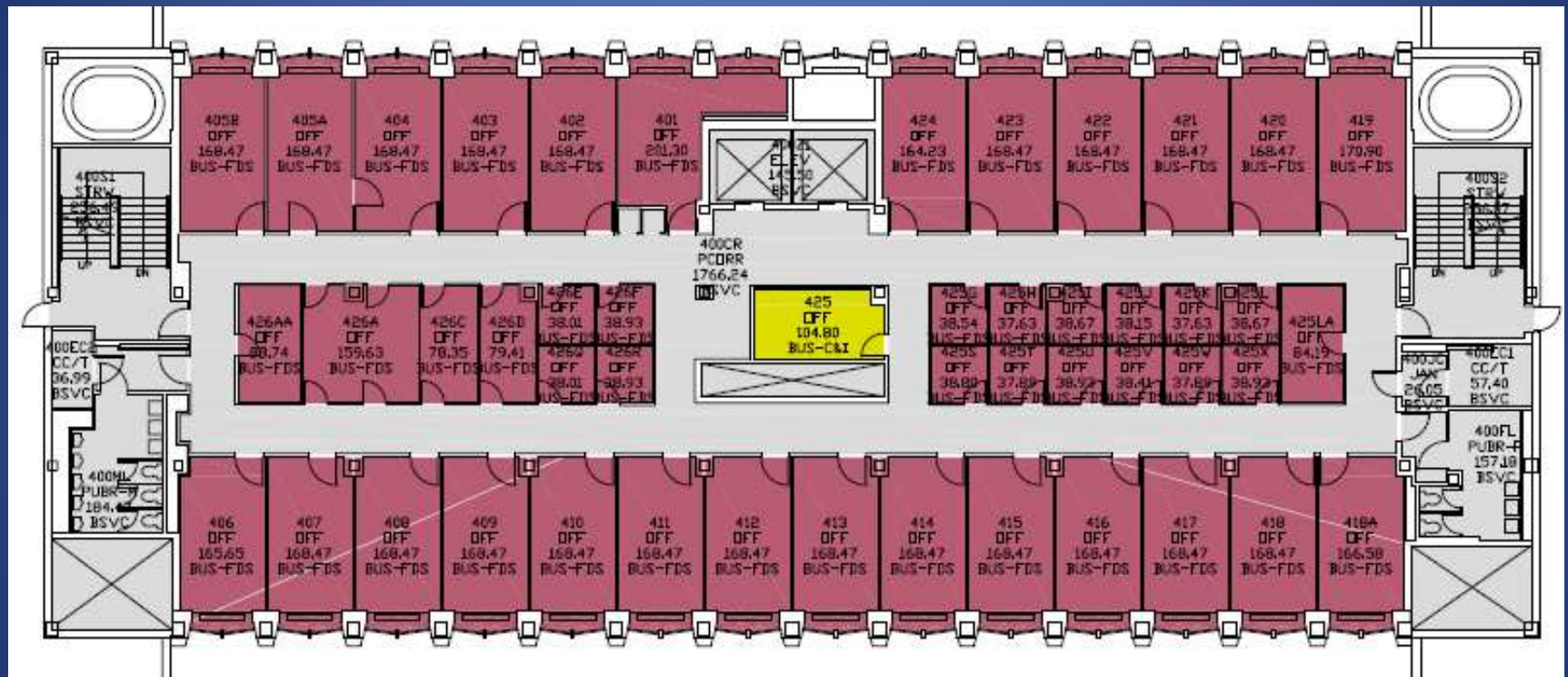

Uris 8th Floor

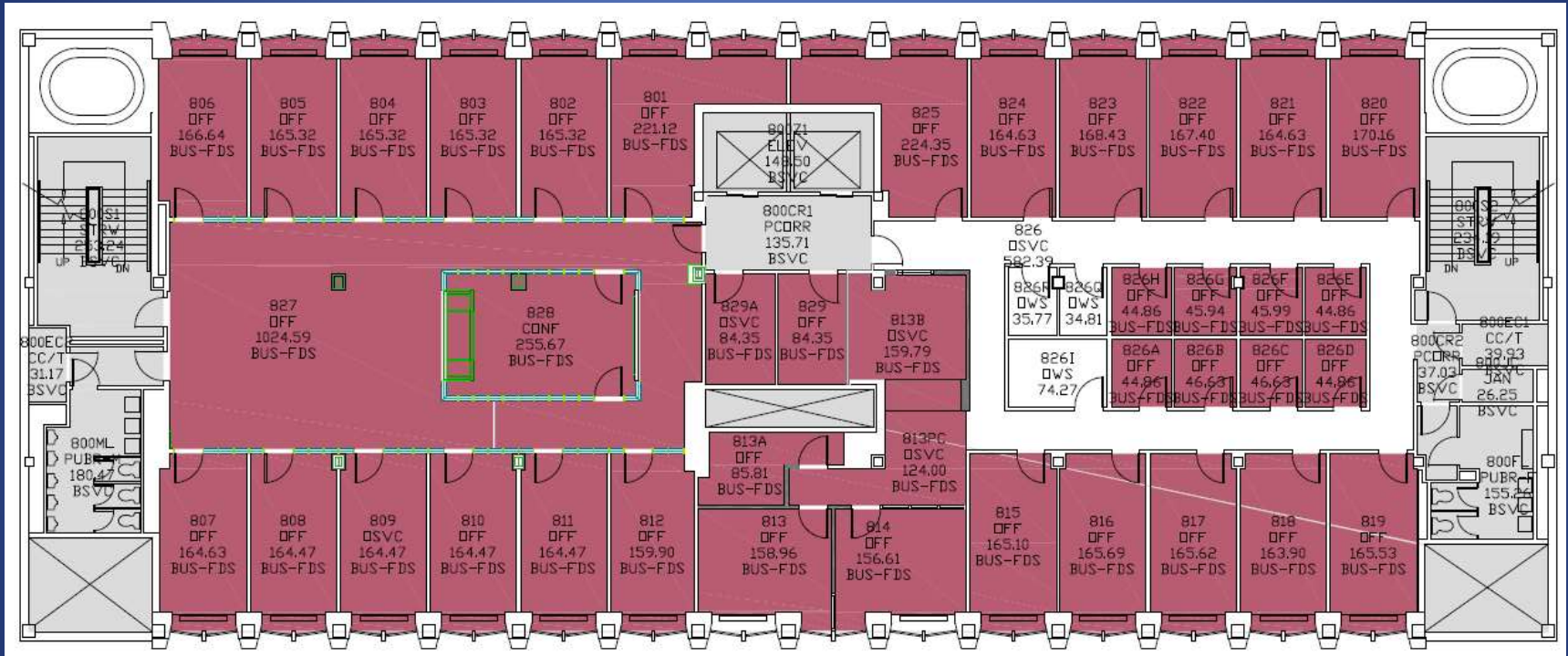

Uris Office Floors

